

PROJECT
PROPOSED RESIDENTIAL COMPLEX OF 3 NOS (G+XX) BUILDINGS & 1NO (G+XX) BUILDING & CLUB BUILDING (G+1) AT -2, KONA EXPRESSWAY, WARD NO-48 BORNIGHT NO-7, LOCALITY - KONA, UNDER HOWRAH MUNICIPAL CORPORATION

GENERAL NOTES
 1. ALL EXTERNAL WALLS 200 THK. A. 80 THK. & INTERNAL WALLS 100 THK. UNLESS SPECIFIED OTHERWISE.
 2. ALL ARCHITECTURAL WORKS ARE TO BE DONE BY CONTRACTOR AS PER THE ARCHITECT'S DRAWINGS.
 3. ALL WORKS ARE TO BE DONE IN ACCORDANCE WITH THE IS CODES.
 4. ALL CONSTRUCTION WORKS ARE TO BE DONE IN ACCORDANCE WITH THE IS CODES.
 5. ALL CONSTRUCTION WORKS ARE TO BE DONE IN ACCORDANCE WITH THE IS CODES.
 6. ALL CONSTRUCTION WORKS ARE TO BE DONE IN ACCORDANCE WITH THE IS CODES.
 7. ALL CONSTRUCTION WORKS ARE TO BE DONE IN ACCORDANCE WITH THE IS CODES.
 8. ALL CONSTRUCTION WORKS ARE TO BE DONE IN ACCORDANCE WITH THE IS CODES.
 9. ALL CONSTRUCTION WORKS ARE TO BE DONE IN ACCORDANCE WITH THE IS CODES.
 10. ALL CONSTRUCTION WORKS ARE TO BE DONE IN ACCORDANCE WITH THE IS CODES.

SCHEDULE OF DOORS		SCHEDULE OF WINDOWS	
NO.	SIZE	NO.	SIZE
D1	2150 x 2150	W1	2000 x 1500
D2	1500 x 2150	W2	2150 x 2000
D3	1000 x 2150	W3	1500 x 1500
D4	2150 x 1500	W4	1500 x 1500
D5	2150 x 1500	W5	1500 x 1500
D6	2150 x 1500	W6	1500 x 1500
D7	2150 x 1500	W7	1500 x 1500
D8	2150 x 1500	W8	1500 x 1500
D9	2150 x 1500	W9	1500 x 1500
D10	2150 x 1500	W10	1500 x 1500

UNREPEATING
 THE ARCHITECT HAS ADVISED THE USER THAT CAREFUL ON-SITE SUPERVISION IS REQUIRED TO ENSURE THAT THE WORK IS DONE IN ACCORDANCE WITH THE ARCHITECT'S DRAWINGS. THE ARCHITECT IS NOT RESPONSIBLE FOR ANY DEFICIENCIES OR DAMAGES TO THE WORK OR TO THE USER'S PROPERTY OR TO THE USER'S PERSONS OR TO THE USER'S OTHER PROPERTY OR TO THE USER'S OTHER PERSONS OR TO THE USER'S OTHER PROPERTY OR TO THE USER'S OTHER PERSONS.

SIGNATURE OF ARCHITECT
 CHANDI PRASAD KHANRA
 BECOM (INDIA) PVT. LTD.
 L.B.A. License No. 51

SIGNATURE OF OWNER
 Pooj. Real Con Private Limited
 Constituted Attorney

SIGNATURE OF ARCHITECT
 CHANDI PRASAD KHANRA
 BECOM (INDIA) PVT. LTD.
 L.B.A. License No. 51

SIGNATURE OF OWNER
 Pooj. Real Con Private Limited
 Constituted Attorney

SIGNATURE OF ARCHITECT
 CHANDI PRASAD KHANRA
 BECOM (INDIA) PVT. LTD.
 L.B.A. License No. 51

SIGNATURE OF OWNER
 Pooj. Real Con Private Limited
 Constituted Attorney

SIGNATURE OF ARCHITECT
 CHANDI PRASAD KHANRA
 BECOM (INDIA) PVT. LTD.
 L.B.A. License No. 51

SIGNATURE OF OWNER
 Pooj. Real Con Private Limited
 Constituted Attorney

SIGNATURE OF ARCHITECT
 CHANDI PRASAD KHANRA
 BECOM (INDIA) PVT. LTD.
 L.B.A. License No. 51

SIGNATURE OF OWNER
 Pooj. Real Con Private Limited
 Constituted Attorney

SIGNATURE OF ARCHITECT
 CHANDI PRASAD KHANRA
 BECOM (INDIA) PVT. LTD.
 L.B.A. License No. 51

SIGNATURE OF OWNER
 Pooj. Real Con Private Limited
 Constituted Attorney

SIGNATURE OF ARCHITECT
 CHANDI PRASAD KHANRA
 BECOM (INDIA) PVT. LTD.
 L.B.A. License No. 51

SIGNATURE OF OWNER
 Pooj. Real Con Private Limited
 Constituted Attorney

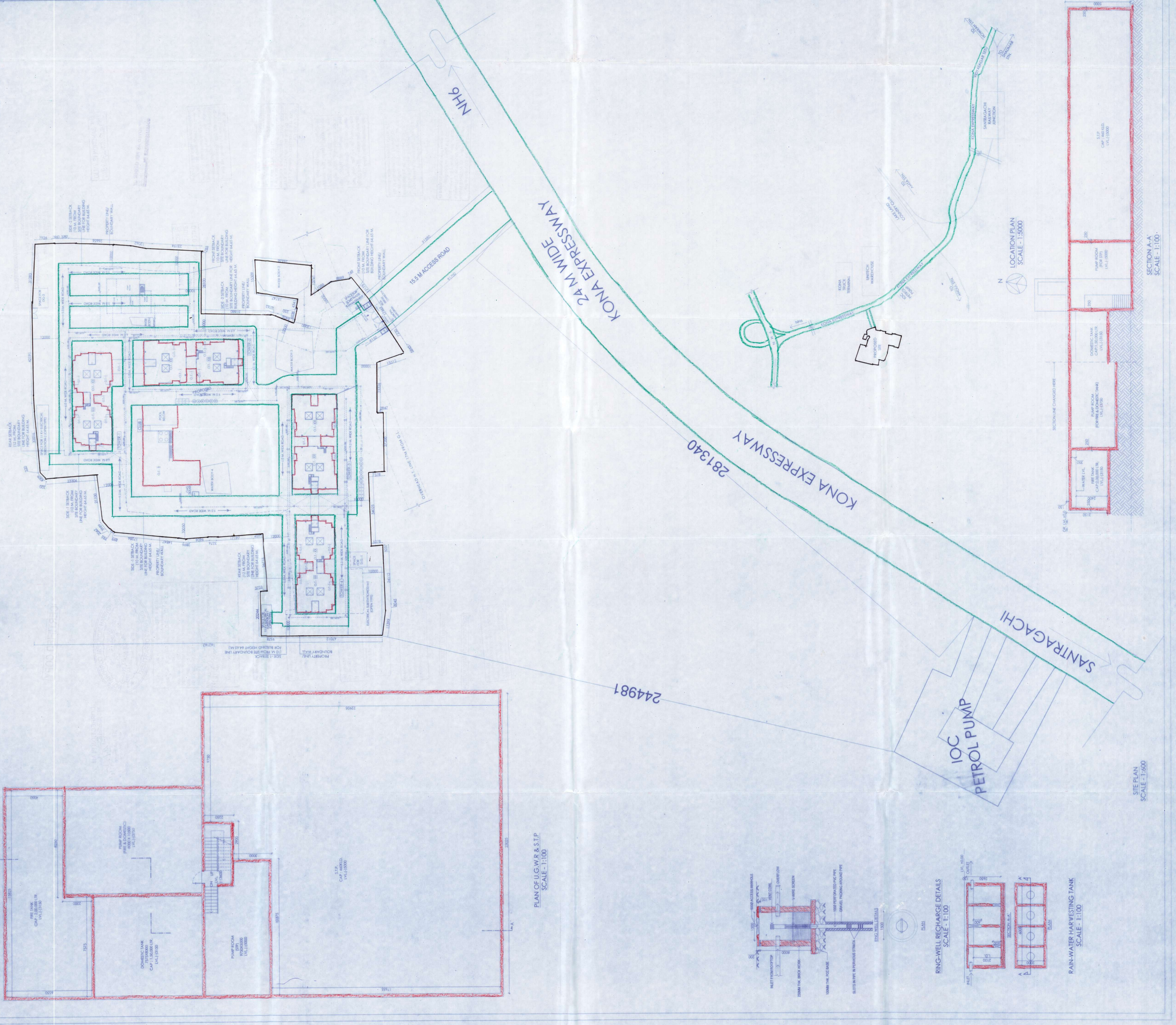

OFFICE OF THE CHIEF ENGINEER
BUILDING DEPARTMENT
HONOLULU, HAWAII

HE SANCTION IS VALID
UP TO 12/31/2011

Approval as per above
Sanctioned by C.E. 11-231

The applicant shall keep at the office of the Chief Engineer a copy of the original and three copies of the approved plans and specifications and shall also keep a copy of the original and three copies of the approved plans and specifications at the office of the Chief Engineer at the address of the project. The Chief Engineer shall be notified immediately in writing of any change in the project or of any other matter which may affect the validity of the approval. The Chief Engineer shall be notified immediately in writing of any change in the project or of any other matter which may affect the validity of the approval.

CONSTRUCTION SITE SHALL BE MAINTAINED TO PREVENT COLLAPSE OF EXISTING STRUCTURES AND TO PROTECT ALL UTILITIES, WELLS, VESSELS, BASEMENTS, FOUNDATIONS, ETC. FROM COLLAPSE OR DAMAGE.

Sanctions Conditional on compliance with the provisions of the Building Code of Hawaii, Chapter 91-19, I.C., and any other applicable laws, rules and regulations. The Chief Engineer shall be notified immediately in writing of any change in the project or of any other matter which may affect the validity of the approval.

The applicant shall keep at the office of the Chief Engineer a copy of the original and three copies of the approved plans and specifications and shall also keep a copy of the original and three copies of the approved plans and specifications at the office of the Chief Engineer at the address of the project. The Chief Engineer shall be notified immediately in writing of any change in the project or of any other matter which may affect the validity of the approval.

PLACED IN MUNICIPAL BUILDING CODE
DATED 8/3/08, 8/3/01

PARTY'S COPY



Sectioned plan per the Building Code of Hawaii, Chapter 91-19, I.C., 91-19-03, 91-19-04, 91-19-05, 91-19-06, 91-19-07, 91-19-08, 91-19-09, 91-19-10, 91-19-11, 91-19-12, 91-19-13, 91-19-14, 91-19-15, 91-19-16, 91-19-17, 91-19-18, 91-19-19, 91-19-20, 91-19-21, 91-19-22, 91-19-23, 91-19-24, 91-19-25, 91-19-26, 91-19-27, 91-19-28, 91-19-29, 91-19-30, 91-19-31, 91-19-32, 91-19-33, 91-19-34, 91-19-35, 91-19-36, 91-19-37, 91-19-38, 91-19-39, 91-19-40, 91-19-41, 91-19-42, 91-19-43, 91-19-44, 91-19-45, 91-19-46, 91-19-47, 91-19-48, 91-19-49, 91-19-50, 91-19-51, 91-19-52, 91-19-53, 91-19-54, 91-19-55, 91-19-56, 91-19-57, 91-19-58, 91-19-59, 91-19-60, 91-19-61, 91-19-62, 91-19-63, 91-19-64, 91-19-65, 91-19-66, 91-19-67, 91-19-68, 91-19-69, 91-19-70, 91-19-71, 91-19-72, 91-19-73, 91-19-74, 91-19-75, 91-19-76, 91-19-77, 91-19-78, 91-19-79, 91-19-80, 91-19-81, 91-19-82, 91-19-83, 91-19-84, 91-19-85, 91-19-86, 91-19-87, 91-19-88, 91-19-89, 91-19-90, 91-19-91, 91-19-92, 91-19-93, 91-19-94, 91-19-95, 91-19-96, 91-19-97, 91-19-98, 91-19-99, 91-19-100.

Sectioned subject to demolition of existing structure and construction of new structure. The applicant shall be notified immediately in writing of any change in the project or of any other matter which may affect the validity of the approval.

The Building Materials necessary for construction shall conform to the standards specified in the National Building Code of Hawaii.

Design of all structural members shall conform to the standards specified in the National Building Code of Hawaii.

Minimum requirements of Section 91-19-03, 91-19-04, 91-19-05, 91-19-06, 91-19-07, 91-19-08, 91-19-09, 91-19-10, 91-19-11, 91-19-12, 91-19-13, 91-19-14, 91-19-15, 91-19-16, 91-19-17, 91-19-18, 91-19-19, 91-19-20, 91-19-21, 91-19-22, 91-19-23, 91-19-24, 91-19-25, 91-19-26, 91-19-27, 91-19-28, 91-19-29, 91-19-30, 91-19-31, 91-19-32, 91-19-33, 91-19-34, 91-19-35, 91-19-36, 91-19-37, 91-19-38, 91-19-39, 91-19-40, 91-19-41, 91-19-42, 91-19-43, 91-19-44, 91-19-45, 91-19-46, 91-19-47, 91-19-48, 91-19-49, 91-19-50, 91-19-51, 91-19-52, 91-19-53, 91-19-54, 91-19-55, 91-19-56, 91-19-57, 91-19-58, 91-19-59, 91-19-60, 91-19-61, 91-19-62, 91-19-63, 91-19-64, 91-19-65, 91-19-66, 91-19-67, 91-19-68, 91-19-69, 91-19-70, 91-19-71, 91-19-72, 91-19-73, 91-19-74, 91-19-75, 91-19-76, 91-19-77, 91-19-78, 91-19-79, 91-19-80, 91-19-81, 91-19-82, 91-19-83, 91-19-84, 91-19-85, 91-19-86, 91-19-87, 91-19-88, 91-19-89, 91-19-90, 91-19-91, 91-19-92, 91-19-93, 91-19-94, 91-19-95, 91-19-96, 91-19-97, 91-19-98, 91-19-99, 91-19-100.

RESIDENTIAL BUILDING

NECESSARY STAFF SHOULD BE STATIONED AT THE SITE OF THE ADDITION OF THE STRUCTURE TO MONITOR THE CONSTRUCTION AND TO INSURE THAT THE CONSTRUCTION IS IN ACCORDANCE WITH THE BUILDING CODE OF HAWAII.

SITE PLAN LOCATION PLAN